

LOCATION MAP - SCHEDULE A - PROJECT 22.1
NOT TO SCALE

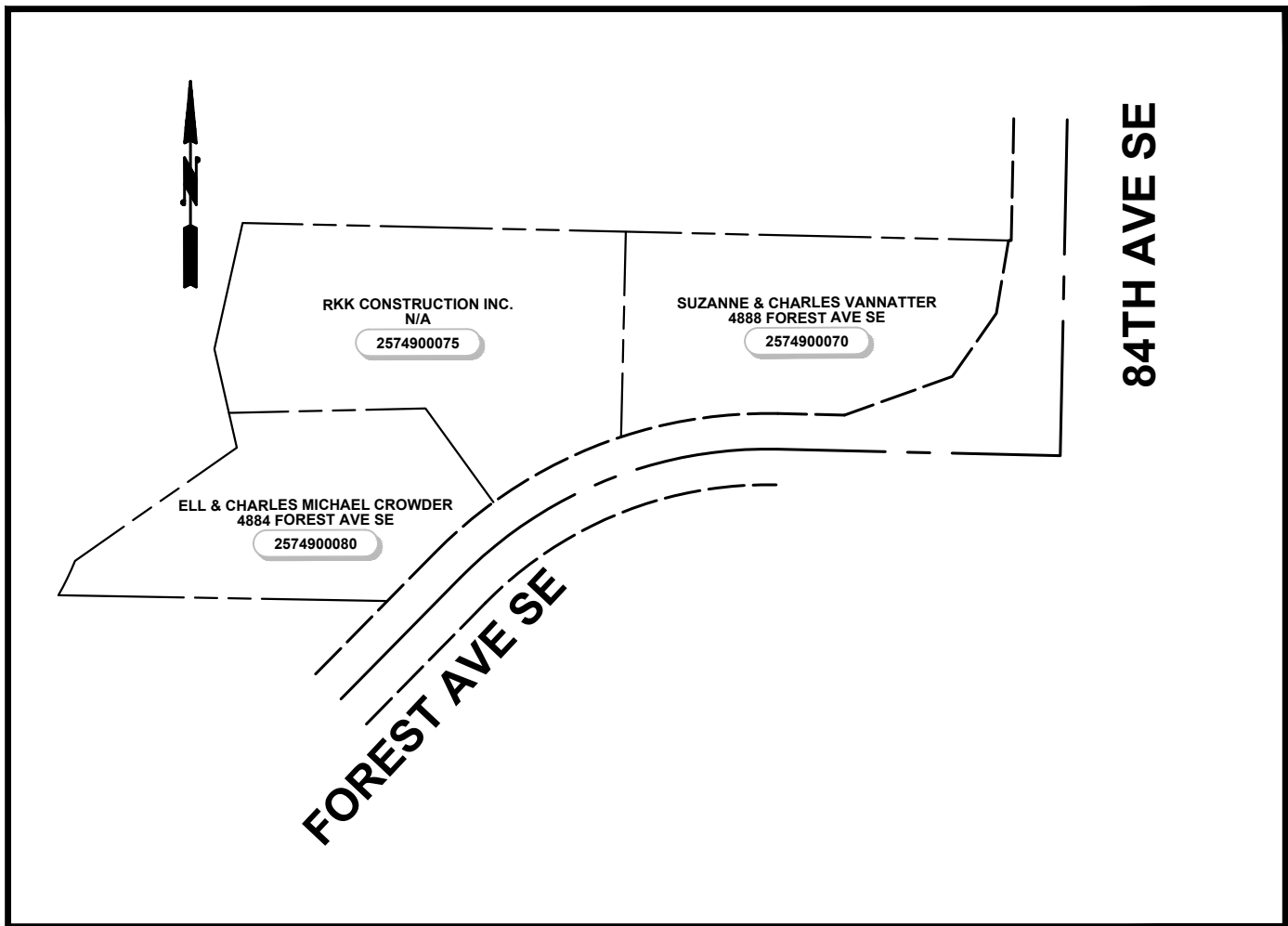
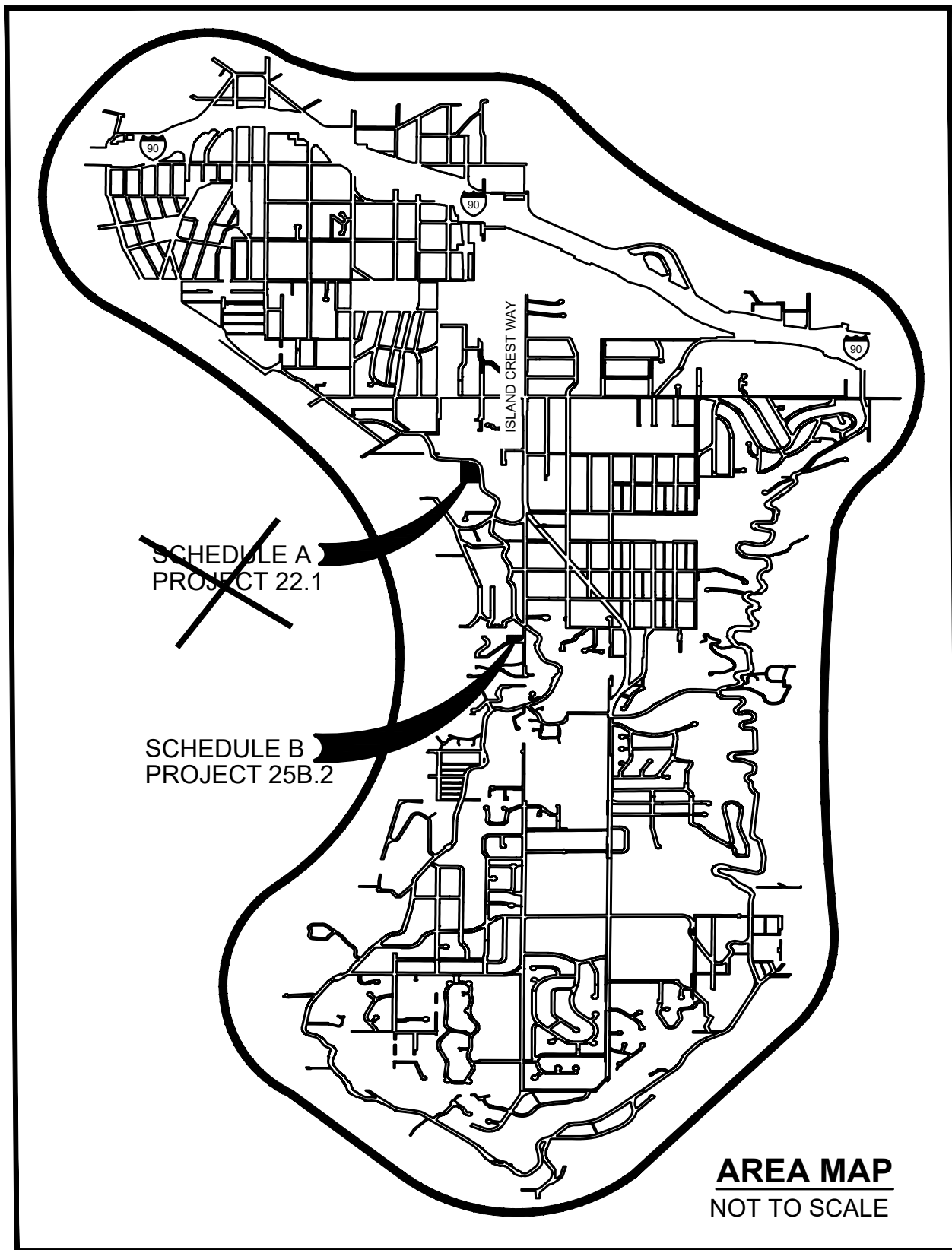

LOCATION MAP - SCHEDULE B - PROJECT 25B.2
NOT TO SCALE

REFERENCE:
 APPLICANT: City of Mercer Island
 ADJACENT PROPERTY OWNERS:
 1. Ellen & Karl W. Zahlis (4241)
 2. Jeffrey P. & Lara A. Sanderson (NA)
 3. Jeffrey P. & Lara A. Sanderson (NA)
 4. Suzanne & Charles Vannatter (4888)
 5. RKK Construction Inc. (NA)
 6. Ell & Charles Michael Crowder (4884)
 *see project location maps above

LOCATION: West Mercer Way &
 Forest Ave SE & 84th Ave SE
~~Schedule A Project 22.1~~
~~LAT/LONG: 47°57' 02" N~~
~~122°23' 06" W~~
 Schedule B Project 25b.2
 LAT/LONG: 47°55' 94" N
 122°22' 75" W

PROPOSED PROJECT:
 Watercourse Stabilization Projects (2)
~~1. Schedule A Project 22.1~~
 2. Schedule B Project 25b.2

 IN: Mercer Island
 NEAR/AT: West Mercer Way
 COUNTY: King
 STATE: Washington
 DATE: December, 2022

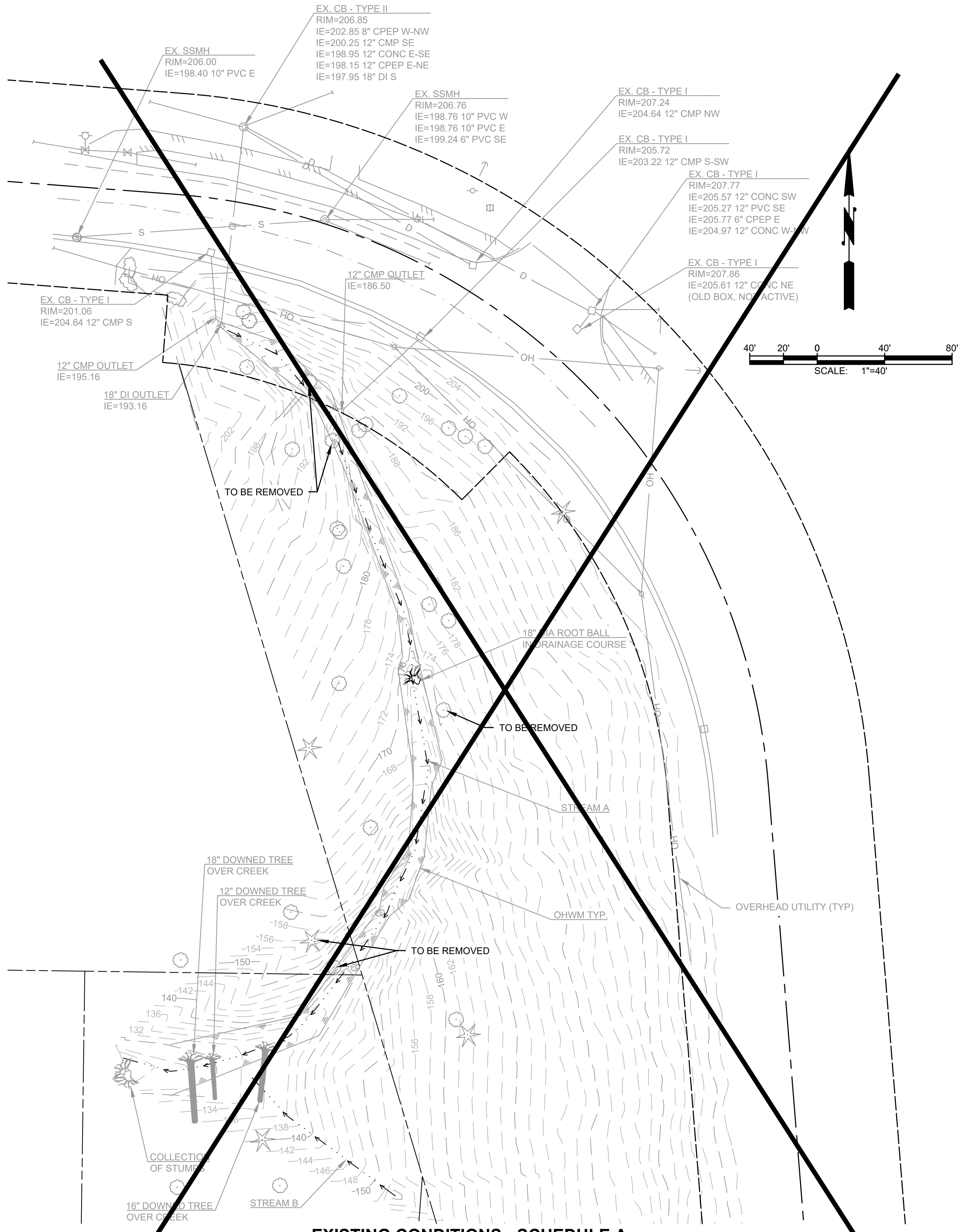

EXISTING CONDITIONS - SCHEDULE A

Reference Number:
 Applicant Name: City of Mercer Island
 Proposed Project: Watercourse Stabilization Projects
 Locations (2): W. Mercer Way & Forest Ave SE
 Page 2 of 13 Date: December, 2022

EX. CB - TYPE I
RIM=167.34
IE=164.29 18" CMP N-NW
IE=164.24 12" CPEP W-SW
IE=164.54 6" PVC E-NE

12" CPEP OUTLET
IE=136.19
(20" BROKEN LOG
OVER OUTLET)

12" CPEP INLET
IE=149.82

12" CMP OUTLET
IE=160.63

WETLAND A

STREAM A

DOWNED LOGS
THIS AREA

TO BE REMOVED

5' GARDEN PATH
W/ R.R. TIES

20" LOG OVER STREAM

12" LOG OVER STREAM

WETLAND B

84TH AVE SE

FOREST AVE SE

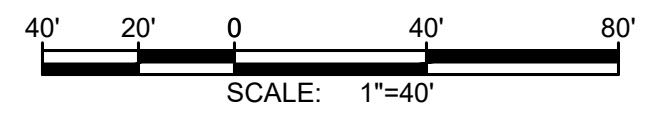

EXISTING CONDITIONS - SCHEDULE B

Reference Number:
Applicant Name: City of Mercer Island
Proposed Project: Watercourse Stabilization Projects
Locations (2): W. Mercer Way & Forest Ave SE
Page 3 of 13 Date: December, 2022

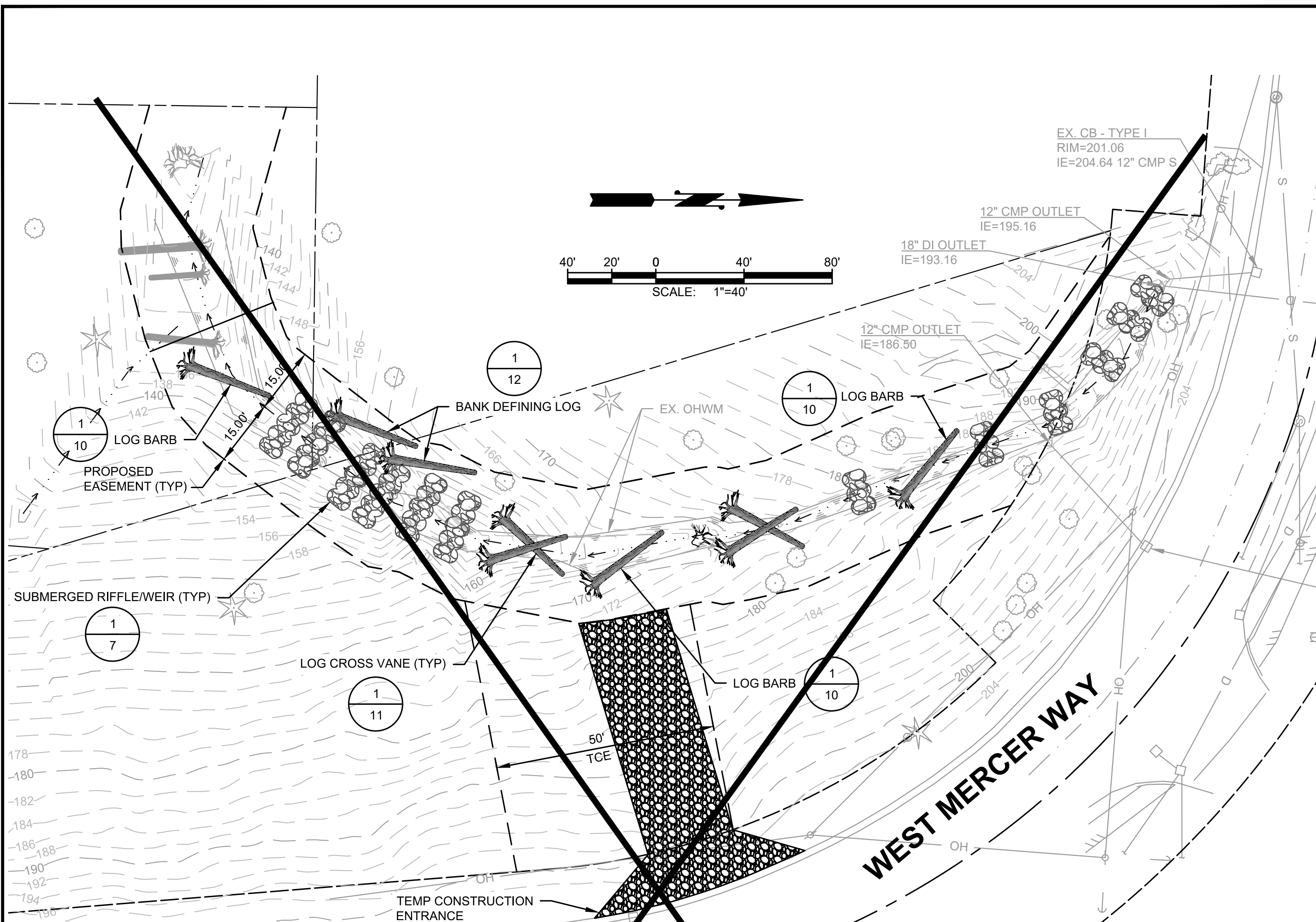

PROPOSED PLAN - SCHEDULE A

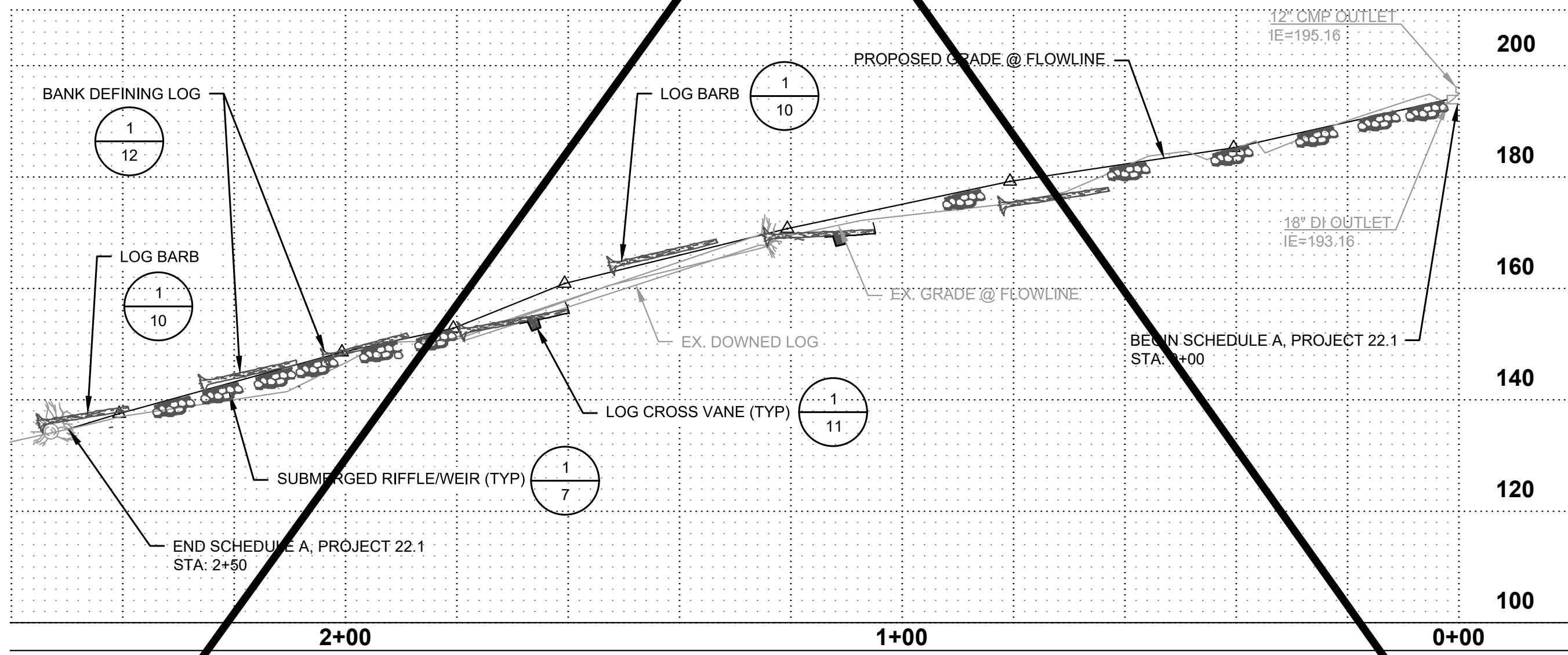

FLOWLINE PROFILE

SCALE: HORIZONTAL 1"=20'
VERTICAL 1"=20'

Reference Number:
 Applicant Name: City of Mercer Island
 Proposed Project: Watercourse Stabilization Projects
 Locations (2): W. Mercer Way & Forest Ave SE
 Page 4 of 13 Date: December, 2022

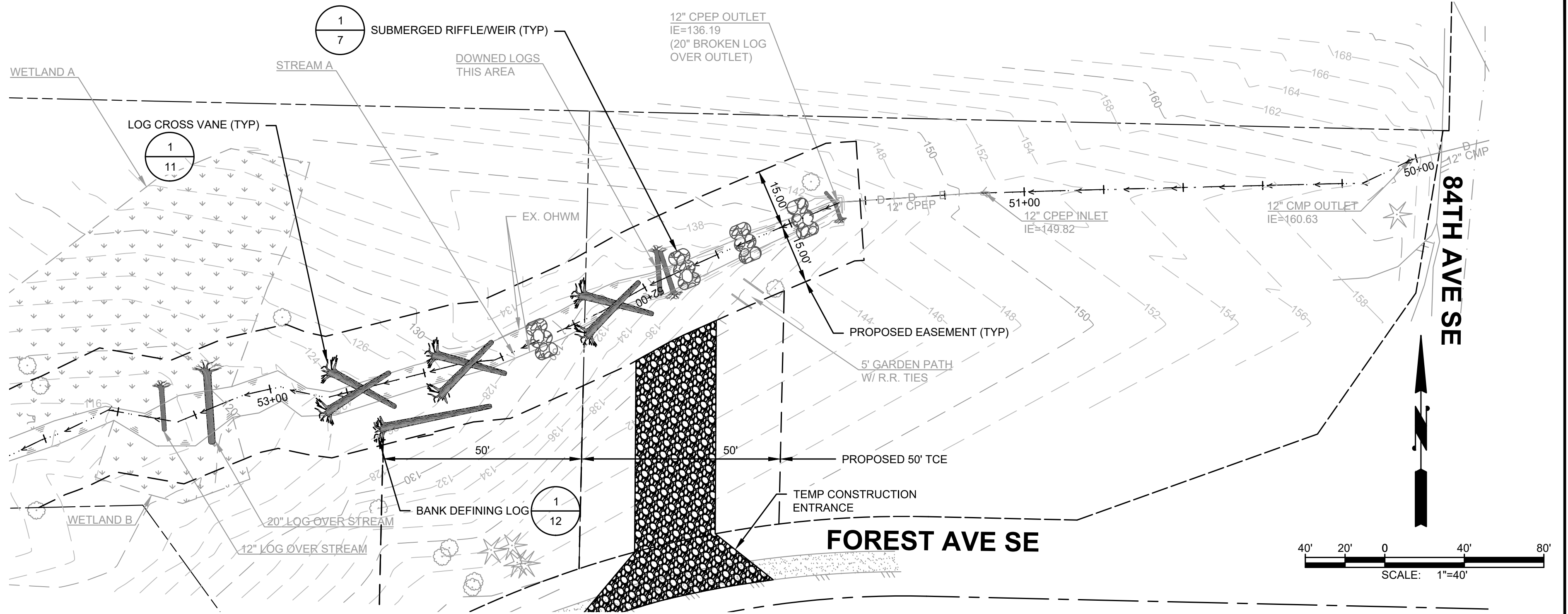

PROPOSED PLAN - SCHEDULE B

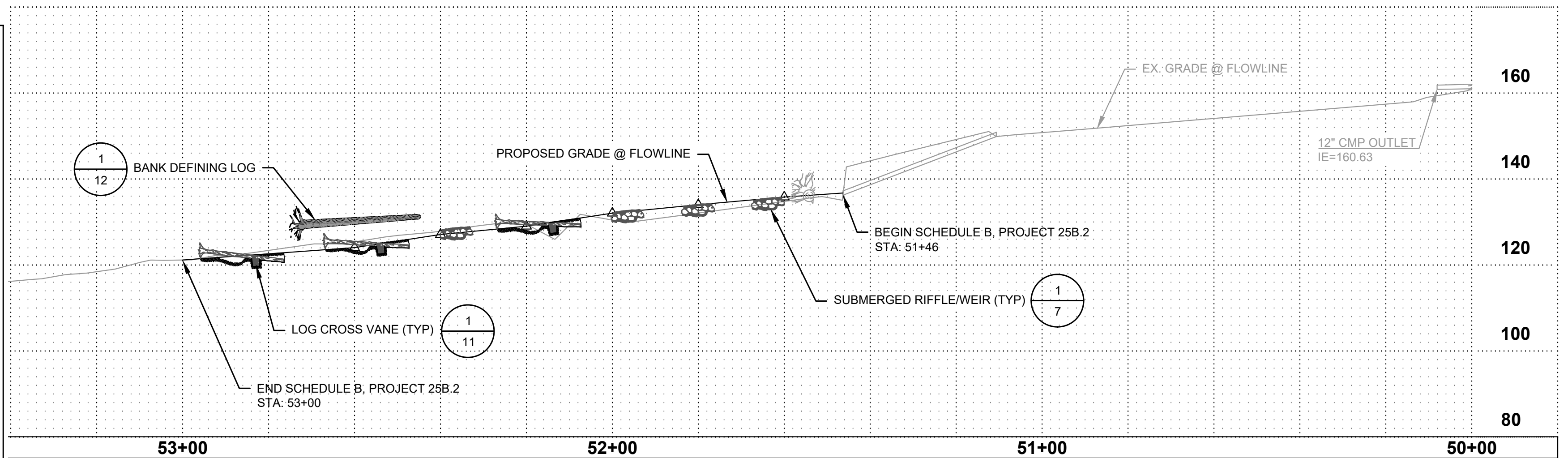

FLOWLINE PROFILE

SCALE: HORIZONTAL 1"=20'
VERTICAL 1"=20'

Reference Number:
Applicant Name: City of Mercer Island
Proposed Project: Watercourse Stabilization Projects
Locations (2): W. Mercer Way & Forest Ave SE
Page 5 of 13 Date: December, 2022

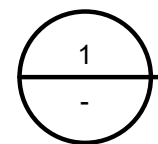
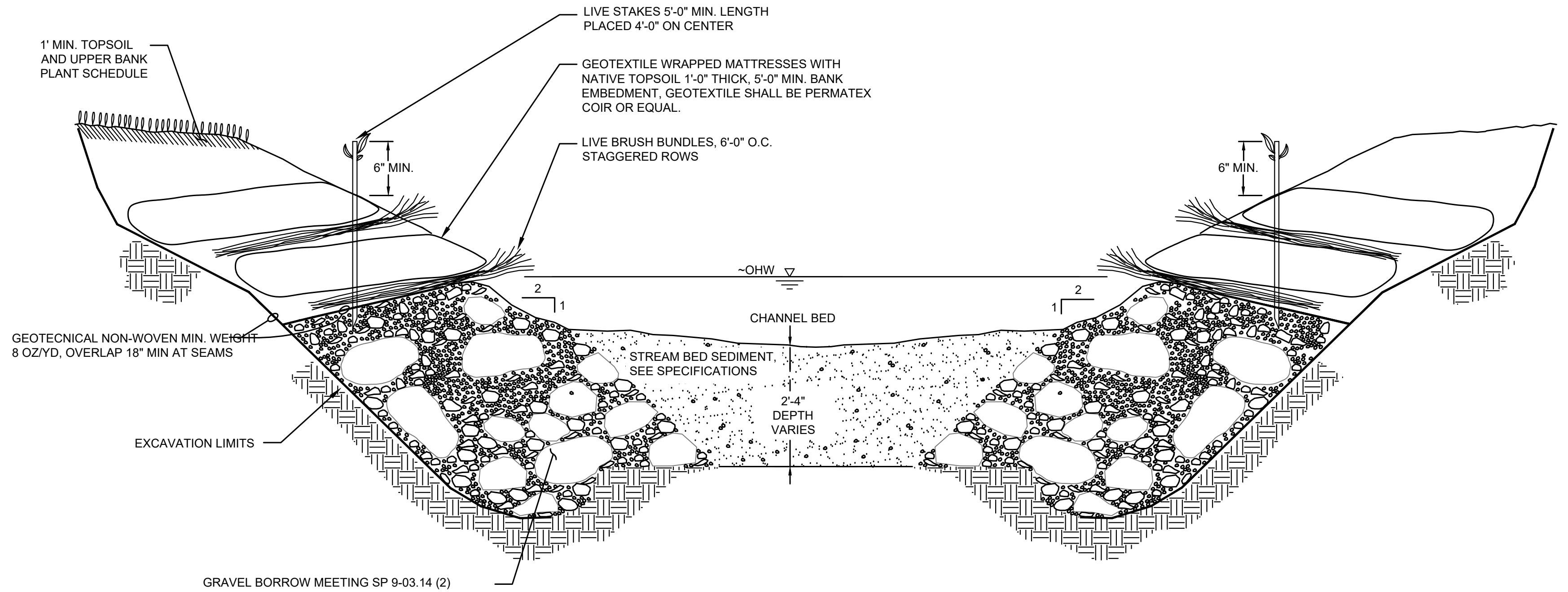

TYPICAL SECTION DETAIL AND BANK PLANTING STABILIZATION

NOT TO SCALE

Reference Number:
 Applicant Name: City of Mercer Island
 Proposed Project: Watercourse Stabilization Projects
 Locations (2): W. Mercer Way & Forest Ave SE
 Page 6 of 13 Date: December, 2022

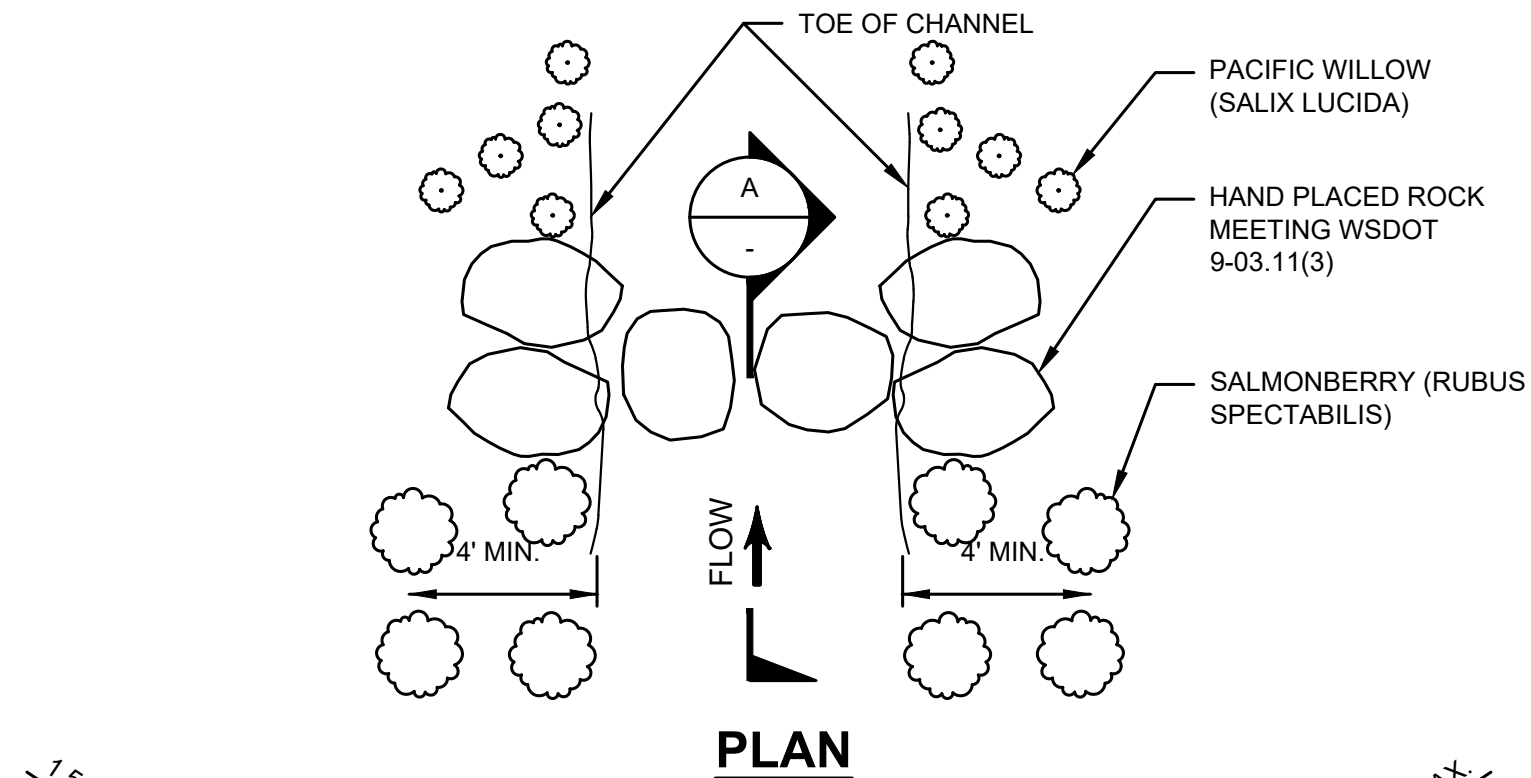

PLAN

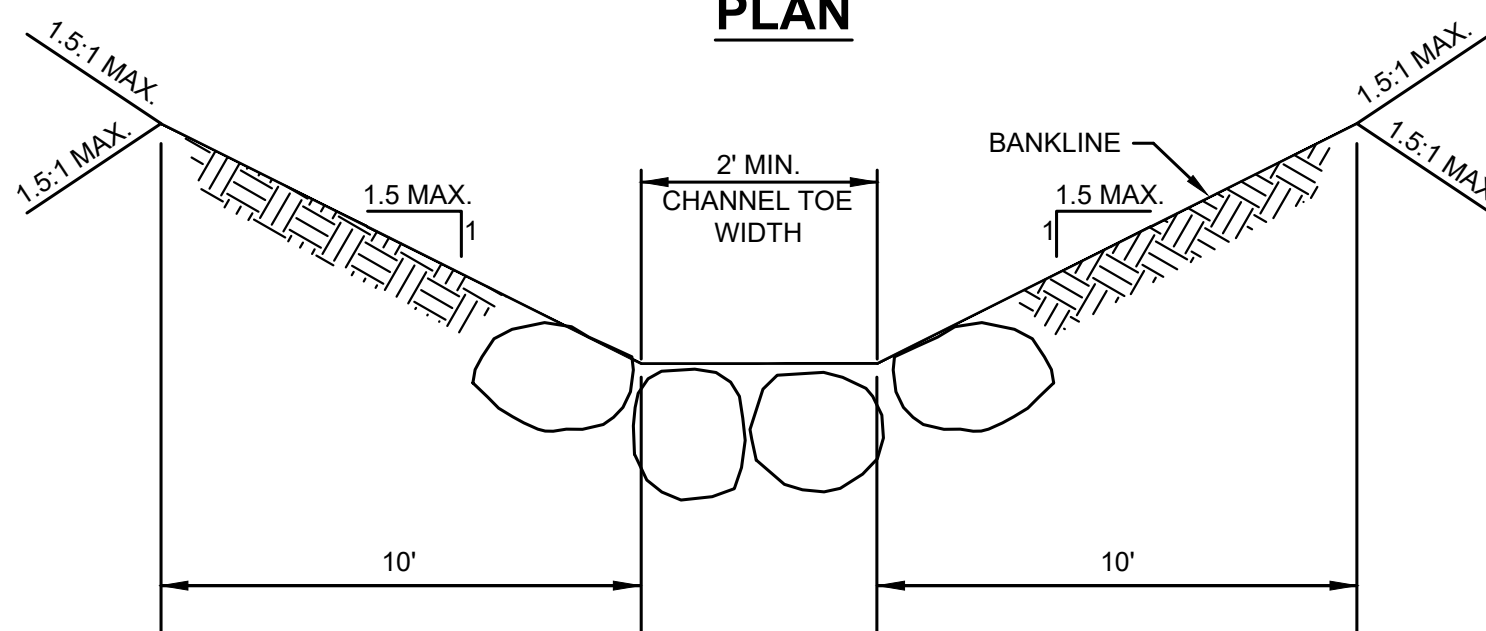

SECTION

1
4,5
SUBMERGED RIFFLE/WEIR
NOT TO SCALE

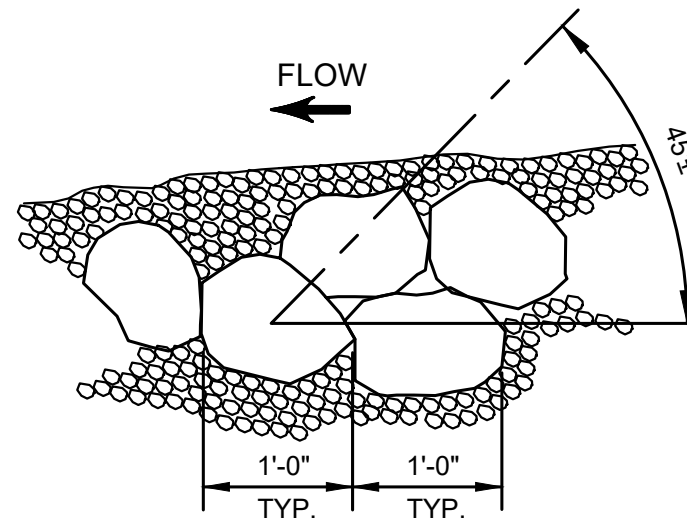

A
-
SUBMERGED RIFFLE/WEIR SECTION
NOT TO SCALE

Reference Number:

Applicant Name: City of Mercer Island
Proposed Project: Watercourse Stabilization Projects

Locations (2): W. Mercer Way & Forest Ave SE
Page 7 of 13 Date: December, 2022

ON SLOPES: SOIL LEVELED AT PLANTING HOLE LOCATION; PLANTS INSTALLED UPRIGHT (SEE NOTE 4)

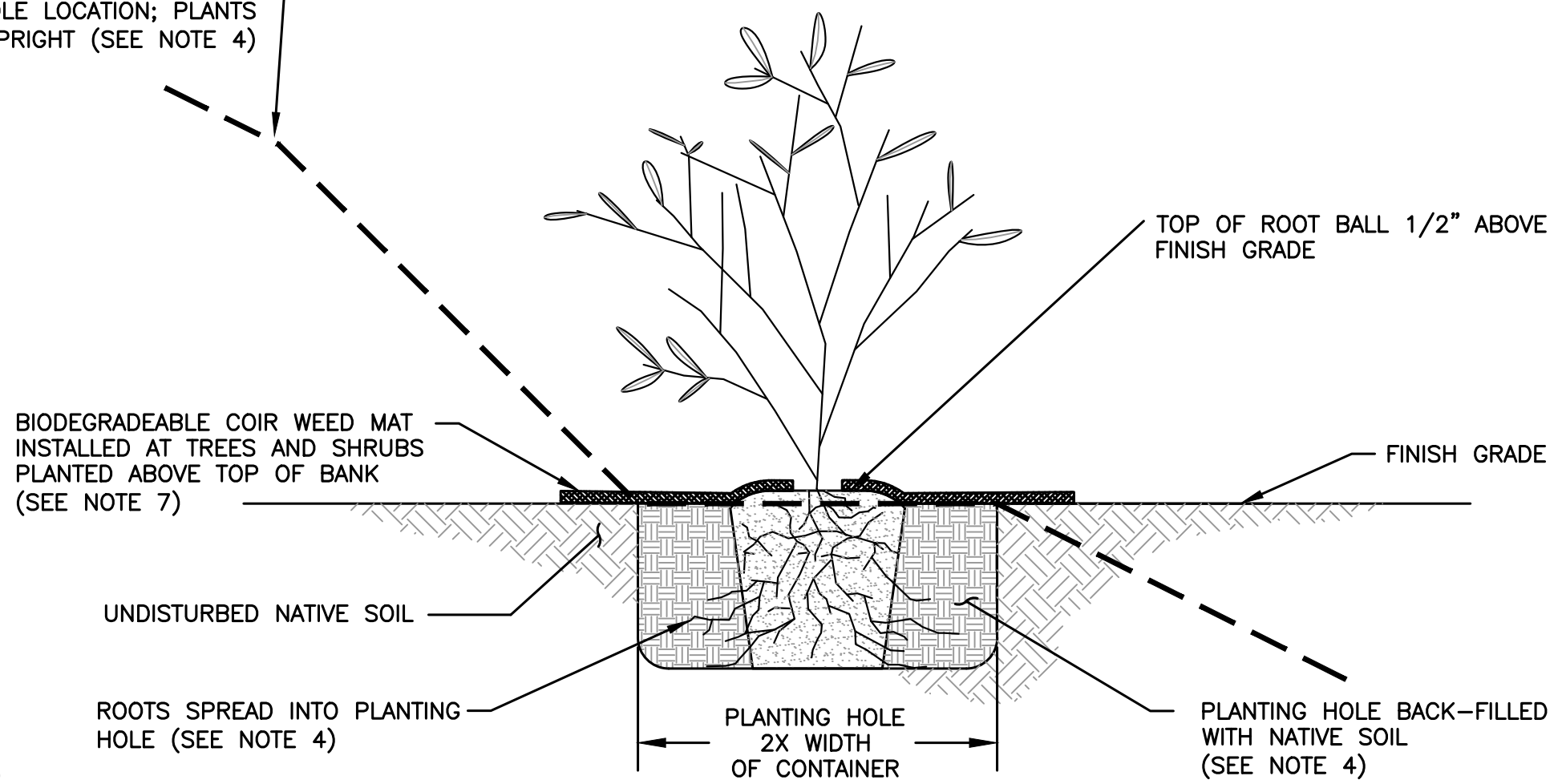

STREAM BANK RESTORATION NOTES

- LIMITS AND GRADES SHOWN ARE APPROXIMATE. FIELD ADJUST PER ENGINEER QUANTITIES FOR BIDDING SHALL BE BASED ON PLANT SCHEDULE.
- PLANT QUANTITIES, SPECIES, AND SPACING ARE INDICATED BELOW.
- LIVE STAKES WHICH ARE NOT PLANTED WITHIN 8 HOURS OF CUTTING SHALL BE SOAKED IN WATER FOR 24 HOURS MINIMUM PRIOR TO INSTALLATION. STAKES WHICH HAVE ALREADY DEVELOPED ROOTS SHALL NOT BE USED. PRIOR TO INSTALLATION OF LIVE STAKE TRIM SIDE BRANCHES CLOSE WITH SHARP BLADE. CREATE PILOT HOLE (1-2" DIAMETER) PERPENDICULAR TO FINISH GRADE. GENTLY INSTALL STAKES, BUTT-END-DOWN, INTO PILOT HOLE. IF STAKES ARE POUNDED INTO PILOT HOLES, USE DEAD-BLOW HAMMER. INSTALL STAKES SUCH THAT APPROXIMATELY 75% OF THE LENGTH OF THE ENTIRE STAKE IS BELOW GRADE AND SUCH THAT A MINIMUM OF 3 BUD SCARS REMAIN ABOVE GRADE. AVOID DAMAGING THE BUDS WHEN INSTALLING THE STAKE. AFTER INSTALLATION, BACKFILL PILOT HOLE WITH NATIVE SOIL. ROCKS, TRASH OR DEBRIS FOUND IN EXCAVATED SOIL SHALL NOT BE USED TO BACKFILL THE PLANTING HOLE. TAMP SOIL AROUND STAKE. BACKFILL SOIL SHALL MAKE GOOD CONTACT WITH THE STAKE, LEAVING NO AIR POCKETS.
- PRIOR TO INSTALLATION OF 1 GALLON CONTAINER PLANTS, CLEANLY PRUNE ANY BROKEN BRANCHES AND SCARIFY OUTER 1 INCH OF ROOTBALL. CLEANLY PRUNE BROKEN, DEAD, OR DISEASED ROOTS. IF ROOTBOUND, TEASE OUT OR CUT CIRCLING ROOTS. EXCAVATE CIRCULAR PLANTING HOLE WITH VERTICAL SIDES AS SHOWN IN DETAIL 2 (THIS SHEET). SCARIFY SIDES AND BOTTOM OF PLANTING HOLE. ON SLOPES, LEVEL SOIL AT PLANTING HOLE LOCATION TO ENSURE COVERAGE OF ROOTS ON DOWNHILL SIDE OF PLANT AND INSTALL PLANT UPRIGHT. PLACE ROOTBALL ON UNDISTURBED NATIVE SOIL AT BASE OF PLANTING HOLE AND SPREAD ROOTS OUT TO SIDES OF PIT. CLEANLY TRIM ANY ROOTS THAT ARE TOO LONG TO LAY STRAIGHT IN PLANTING HOLE. PLANTS SHALL BE UPRIGHT, PLUMB, AND TOP OF ROOTBALL SHALL BE 1/2" ABOVE FINISH GRADE. BACK-FILL PLANTING HOLE WITH NATIVE SOIL EXCAVATED FROM PLANTING HOLE AND TAMP SOIL AROUND ROOTS TO PREVENT AIR POCKETS. ROCKS LARGER THAN 1" DIAMETER AND ANY TRASH OR DEBRIS FOUND IN EXCAVATED SOIL SHALL NOT BE USED TO BACKFILL THE PLANTING HOLE. BACKFILL SOIL SHALL MAKE GOOD CONTACT WITH THE ROOTBALL, LEAVING NO AIR
- IMMEDIATELY AFTER PLANT INSTALLATION, THOROUGHLY WATER IN EACH INSTALLED PLANT OR LIVE STAKE.

1 GALLON TREE & SHRUB PLANTING DETAIL, TYP.

NOT TO SCALE

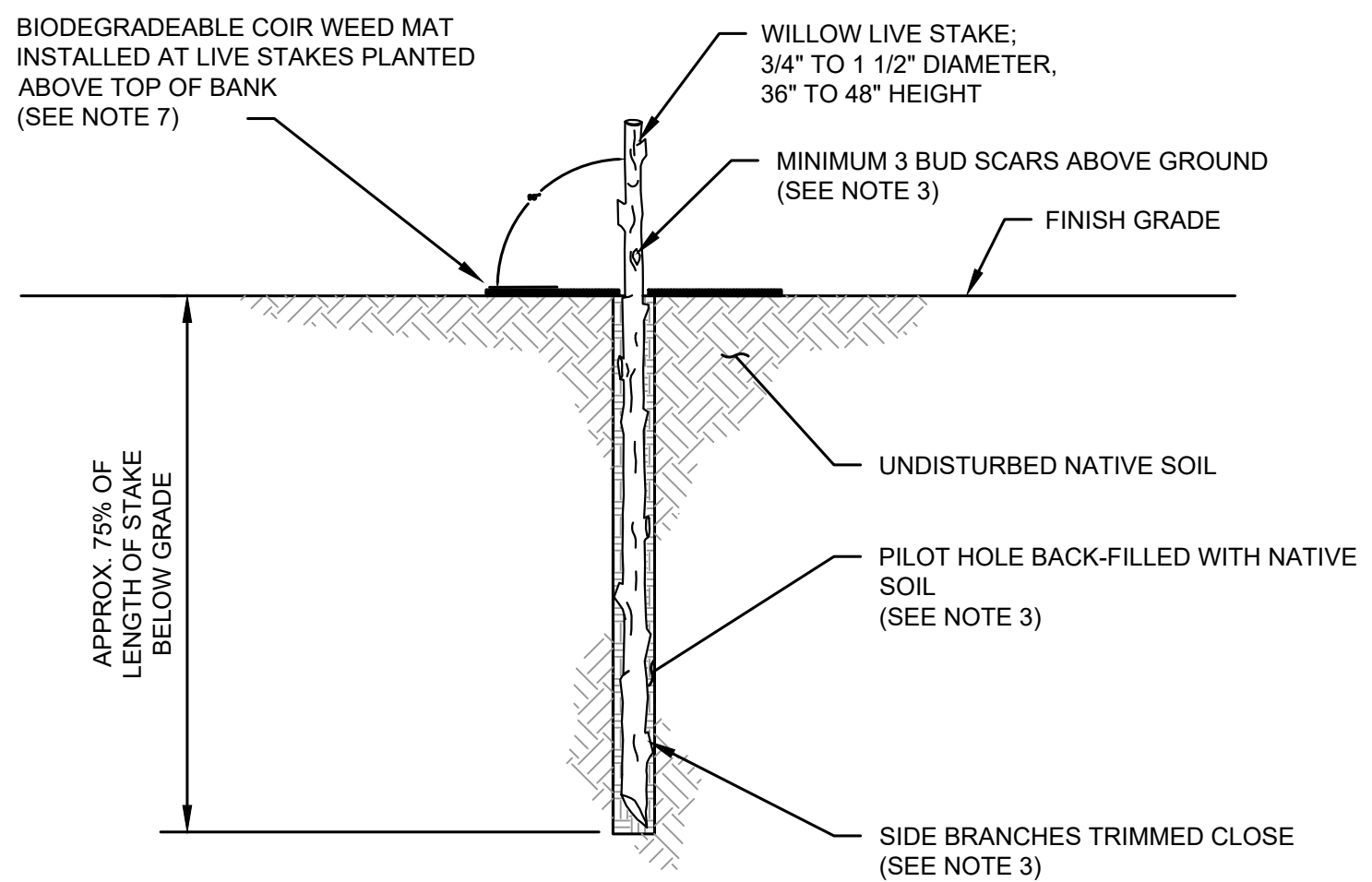

LIVE STAKE INSTALLATION DETAIL, TYP.

NOT TO SCALE

1
-
PLANTING DETAILS
NOT TO SCALE

Reference Number:

Applicant Name: City of Mercer Island
Proposed Project: Watercourse Stabilization Projects

Locations (2): W. Mercer Way & Forest Ave SE
Page 8 of 13 Date: December, 2022

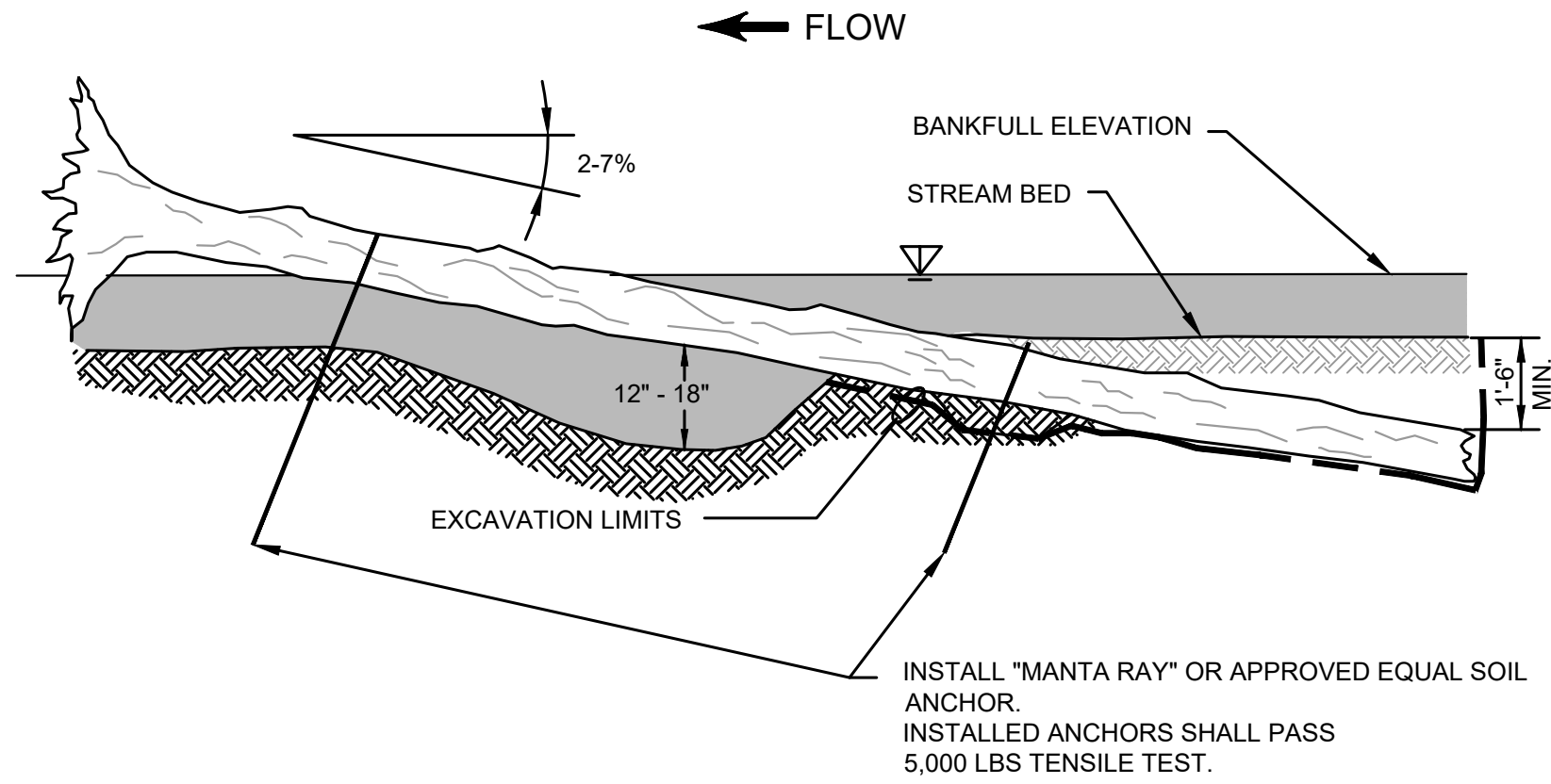

A
-
TYPICAL SECTION
NOT TO SCALE

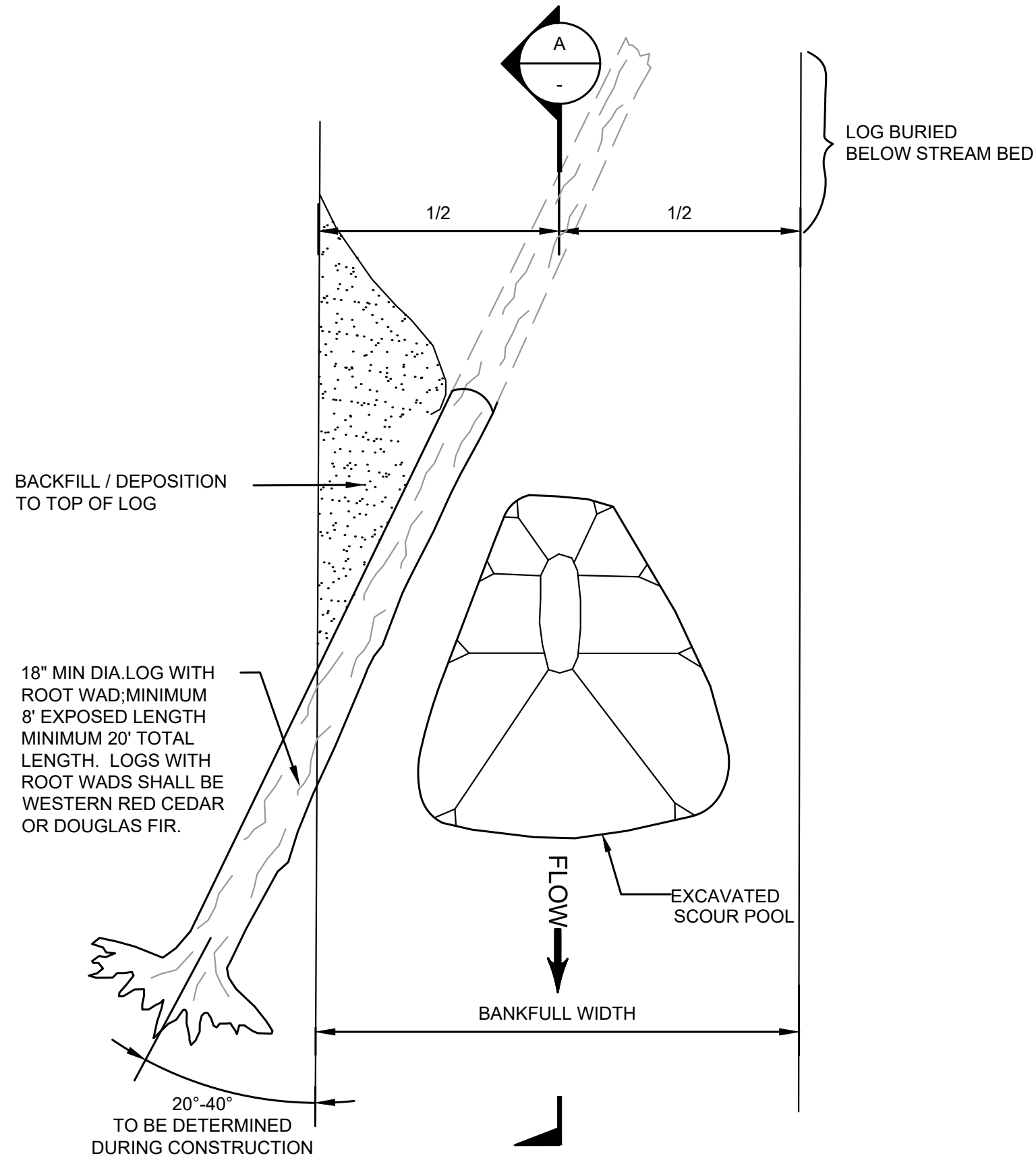

1
4.5
TYPICAL LOG BARB PLAN
NOT TO SCALE

Reference Number:	
Applicant Name:	City of Mercer Island
Proposed Project:	Watercourse Stabilization Projects
Locations (2):	W. Mercer Way & Forest Ave SE
Page 9 of 13	Date: December, 2022

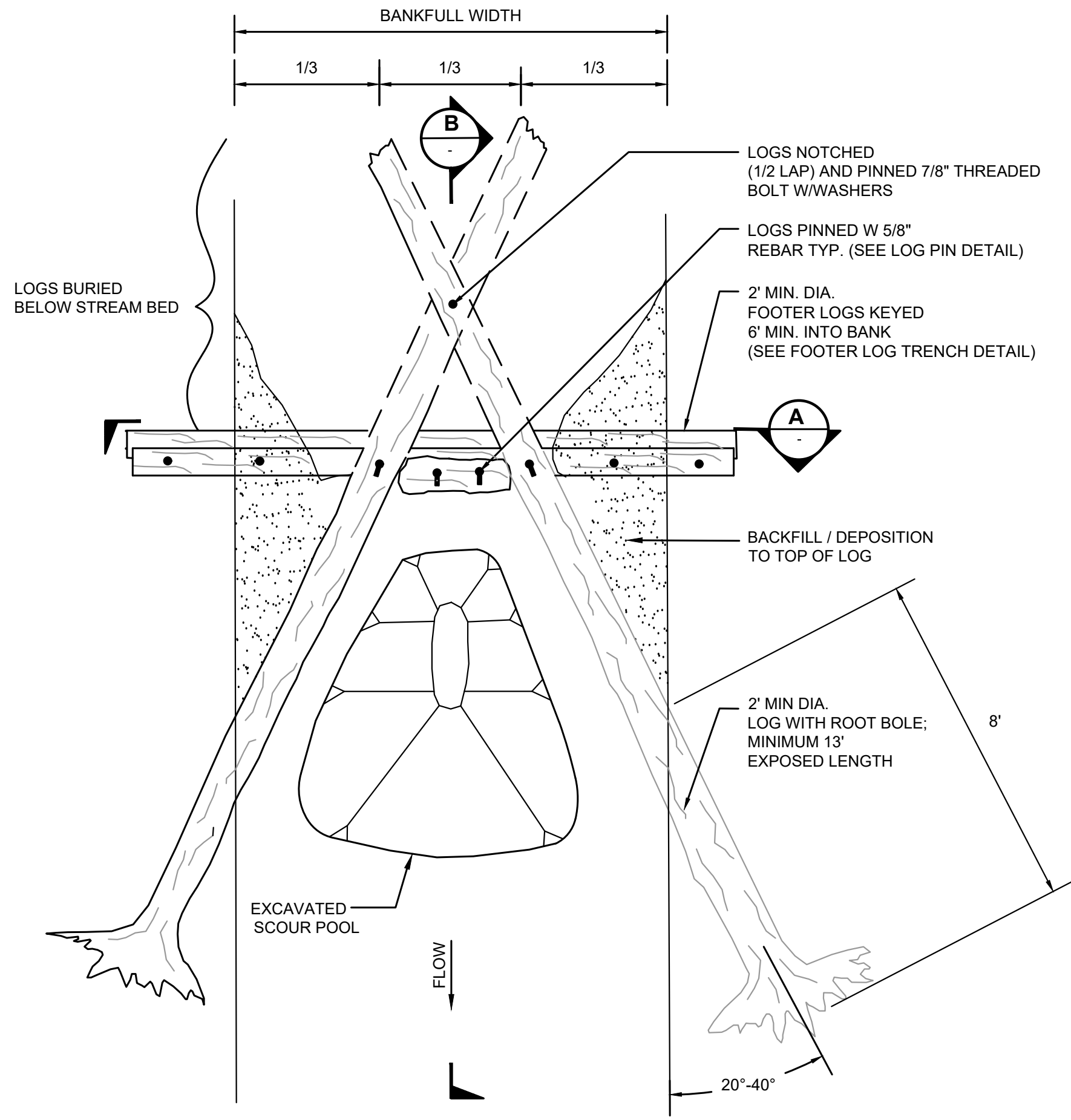

LOG CROSS VANE PLAN
SCALE: NOT TO SCALE

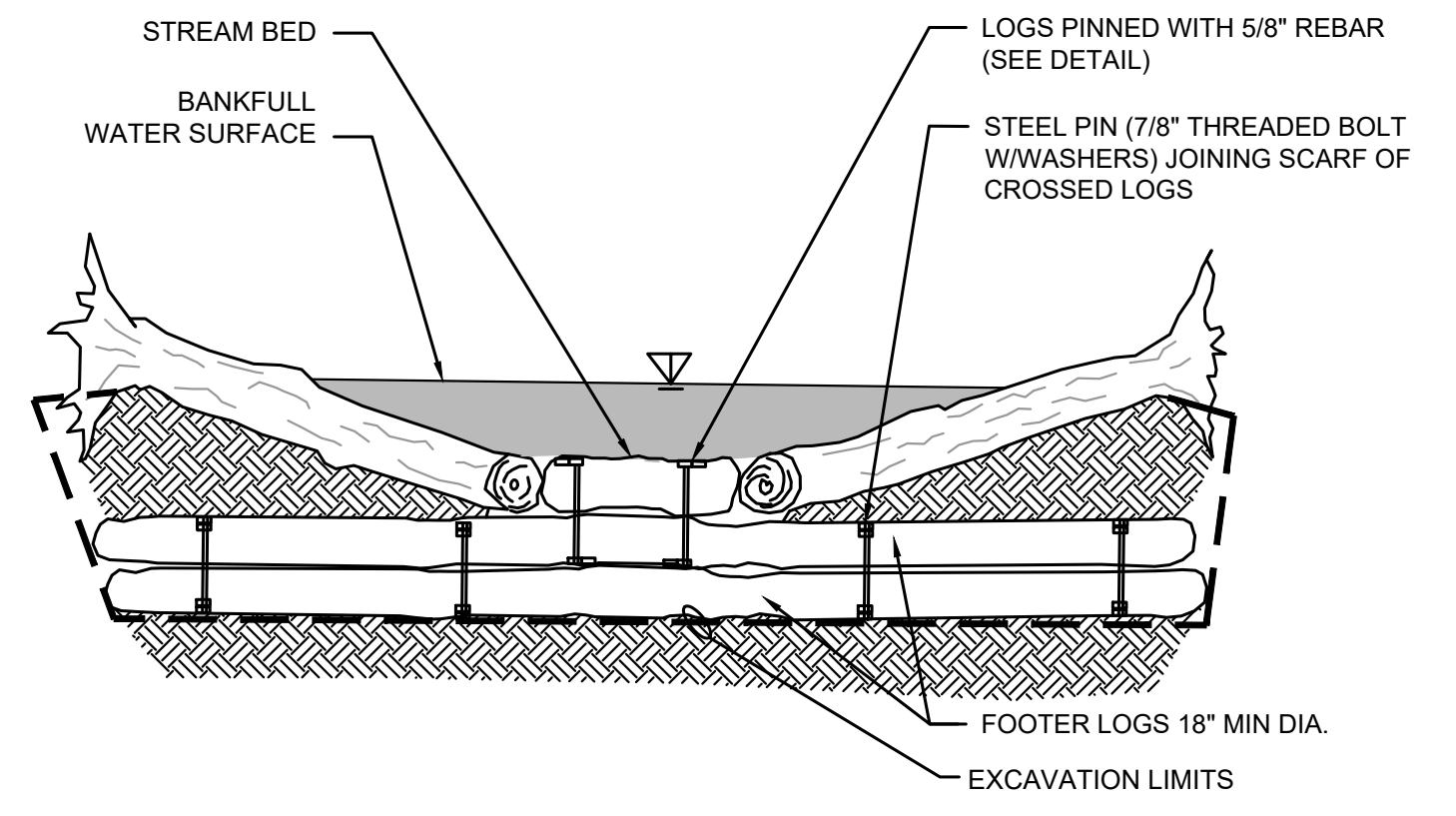

TYPICAL SECTION A
SCALE: NOT TO SCALE

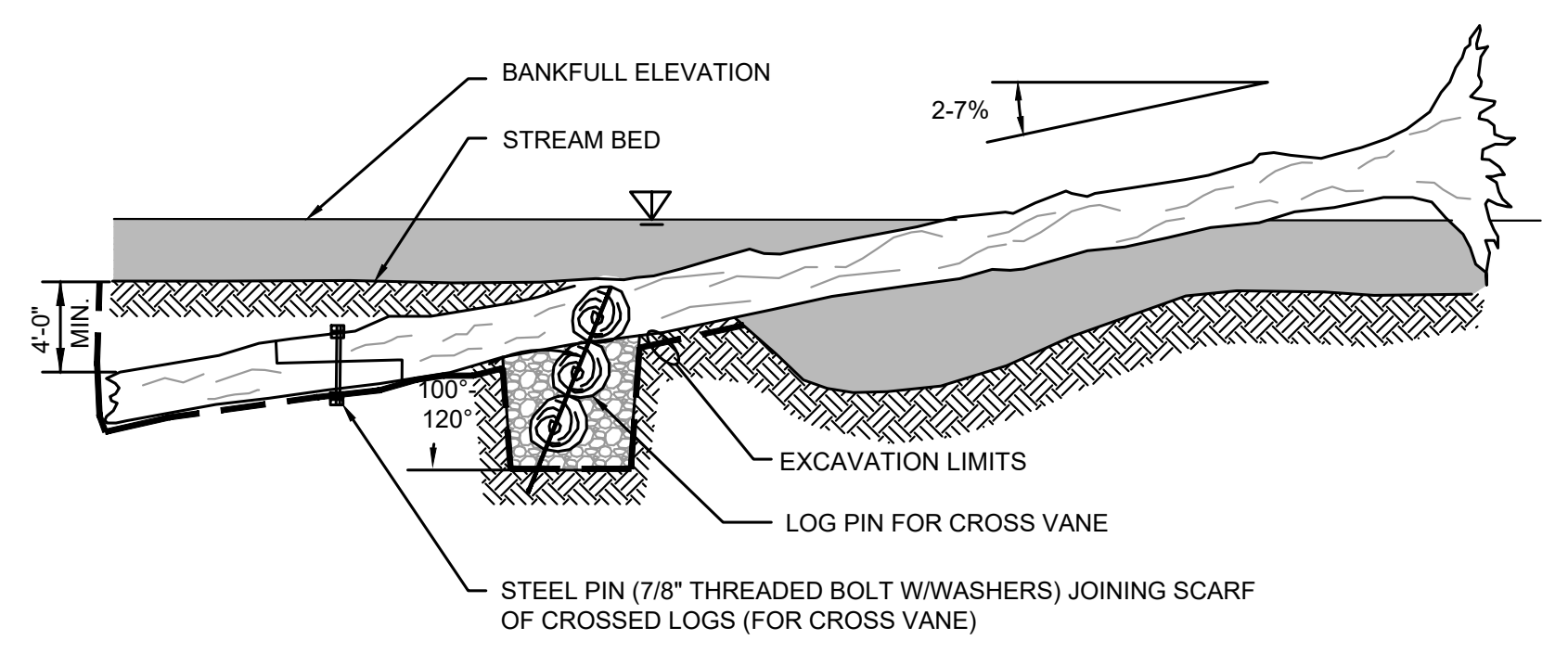

TYPICAL SECTION B
SCALE: NOT TO SCALE

Reference Number:
 Applicant Name: City of Mercer Island
 Proposed Project: Watercourse Stabilization Projects
 Locations (2): W. Mercer Way & Forest Ave SE
 Page 10 of 13 Date: December, 2022

NOTE: BANK LOG TO BE WESTERN RED CEDAR OR DOUGLAS FIR W/ ROOTS ATTACHED AND NO BRANCHES, MIN. 22 FEET IN LENGTH AND 12 INCHES IN DIAMETER, 22 FEET FROM ROOT END.

CHAIN ROOT WAD TO MANTA RAY MR-3 ANCHOR 7' MIN. INTO GROUND USING 5/16" DIA. MIN. GRADE 40 GALV. STEEL CHAIN MAKING TWO COMPLETE WRAPS AROUND LOG AND SECURE W/ SHACKLES OR OTHER APPROVED CONNECTION DEVICE RATED TO PERMANENTLY HOLD THE SAME LOAD AS SPECIFIED FOR THE ANCHOR. SCORE ROOT WAD TO RECESS CHAIN.

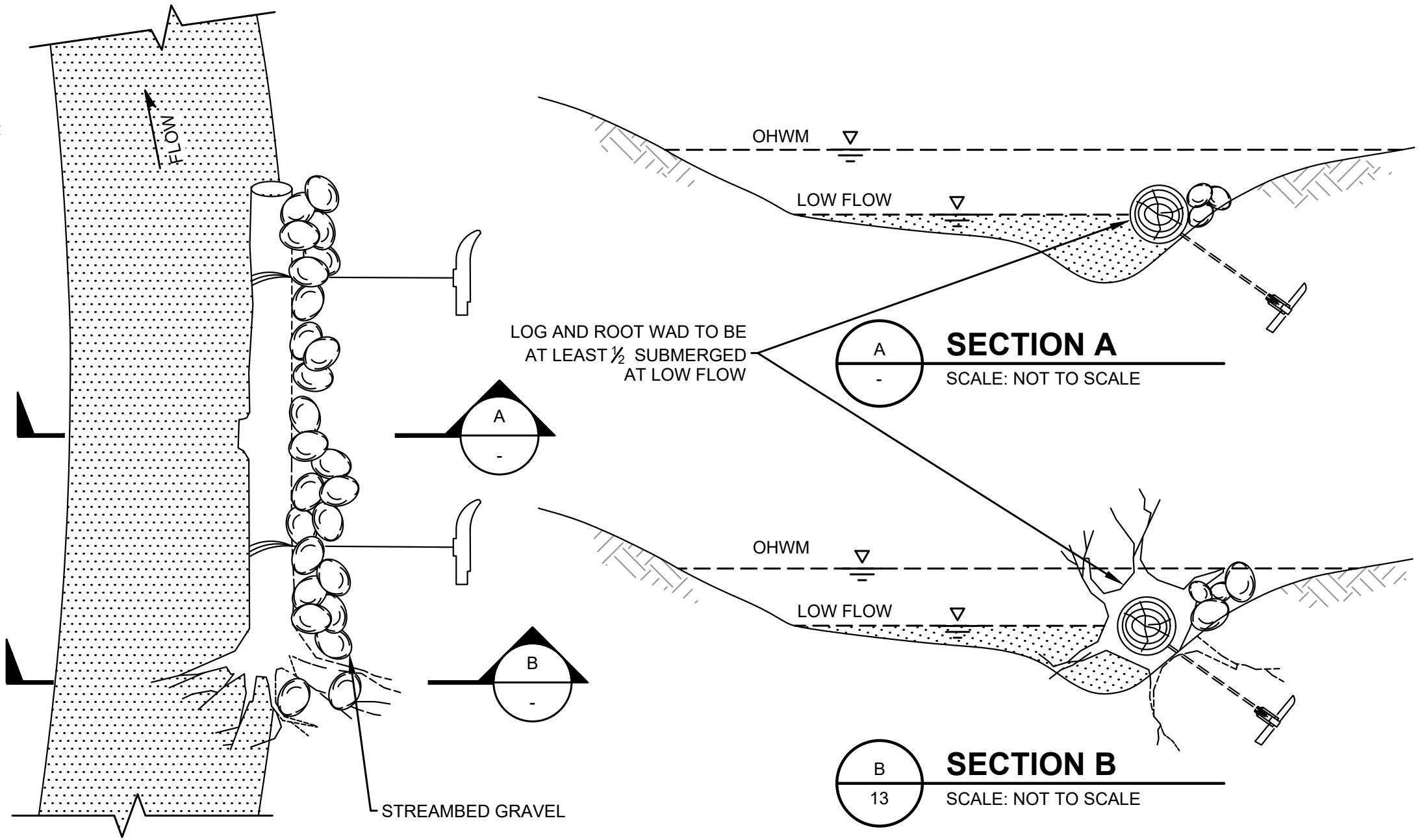

1
4,5
TYPICAL BANK LOG INSTALLATION
SCALE: NOT TO SCALE

Reference Number:	
Applicant Name:	City of Mercer Island
Proposed Project:	Watercourse Stabilization Projects
Locations (2):	W. Mercer Way & Forest Ave SE
Page 11 of 13	Date: December, 2022

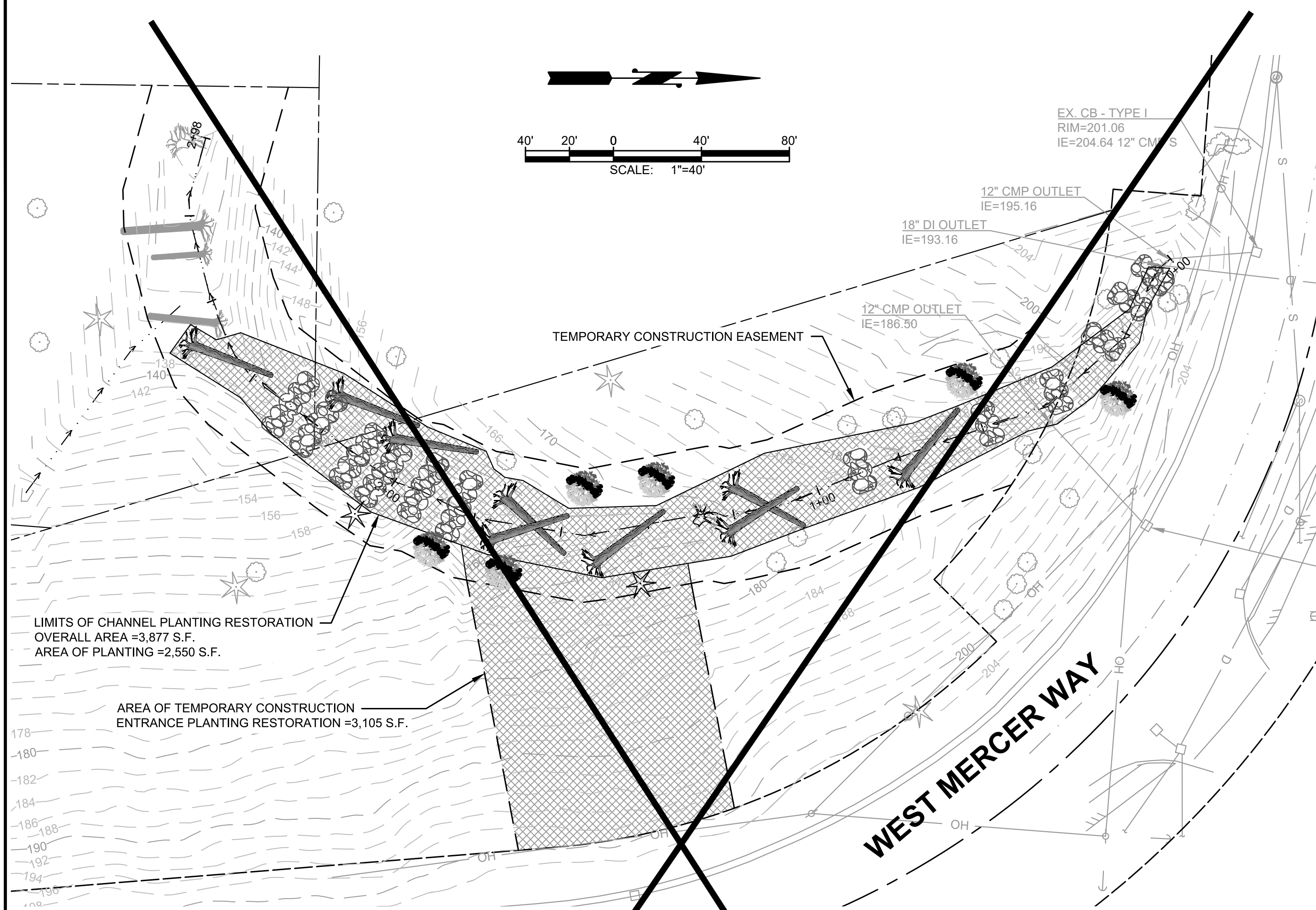
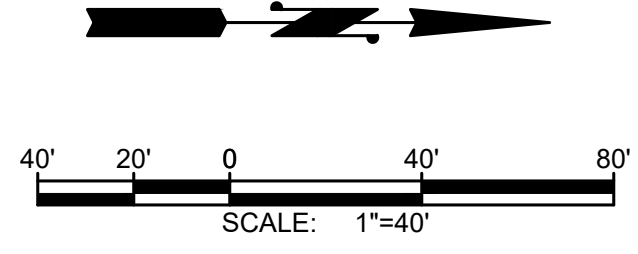

PROPOSED RESTORATION PLAN SCHEDULE A

PLANT SCHEDULE

PLANTING AREA	SYMBOL	SPECIES		SPACING (O.C.)	QTY	TYPE & SIZE	NOTES
TOTAL AREA OF SCHEDULE A PLANTING AREA 2,550 S.F.		<i>Thuja plicata</i>	WESTERN RED CEDAR	10'	2	5-GALLON CONTAINER	AS NOTED ON PLANS
		<i>Alnus rubra</i>	RED ALDER	10'	6	5-GALLON CONTAINER	AS NOTED ON PLANS
		<i>Rubus spectabilis</i>	SALMONBERRY	4'	20	1-GALLON CONTAINER	PLANT IN SINGLE-SPECIES GROUPS OF 2-3 PLANTS
		<i>Symphoricarpos albus</i>	SNOWBERRY	4'	20	1-GALLON CONTAINER	PLANT IN SINGLE-SPECIES GROUPS OF 2-3 PLANTS
		<i>Rosa nutkana</i>	NOOTKA ROSE	4'	20	1-GALLON CONTAINER	PLANT IN SINGLE-SPECIES GROUPS OF 2-3 PLANTS
		<i>Athyrium lilix-femina</i>	LADY FERN	1.5'	40	1-GALLON CONTAINER	PLANT IN SINGLE-SPECIES GROUPS OF 2-3 PLANTS
		<i>Tellima grandiflora</i>	FRINGE CUP	1.5'	40	1-GALLON CONTAINER	PLANT IN SINGLE-SPECIES GROUPS OF 2-3 PLANTS
		<i>salix lucinda</i>	PACIFIC WILLOW	12"	100	LIVE STAKE	AS NOTED ON PLANS
		See Spec	GRASS MIX	---	---	---	---

NOTE: GRASS MIX SHALL CONSIST OF NATIVE SPECIES OF FESCUE CONTAINING VARIOUS PROPORTIONS OF RED FESCUE (*FESTUCA RUBRA*), TALL FESCUE (*FESTUCA ARUNDINACEA*), AND WESTERN FESCUE (*FESTUCA OCCIDENTALIS*). SEEDS SHALL BE "WEED FREE" INDICATING THERE ARE NO NOXIOUS OR NUISANCE WEEDS IN THE SEED.

Reference Number:
 Applicant Name: City of Mercer Island
 Proposed Project: Watercourse Stabilization Projects
 Locations (2): W. Mercer Way & Forest Ave SE
 Page 12 of 13 Date: December, 2022

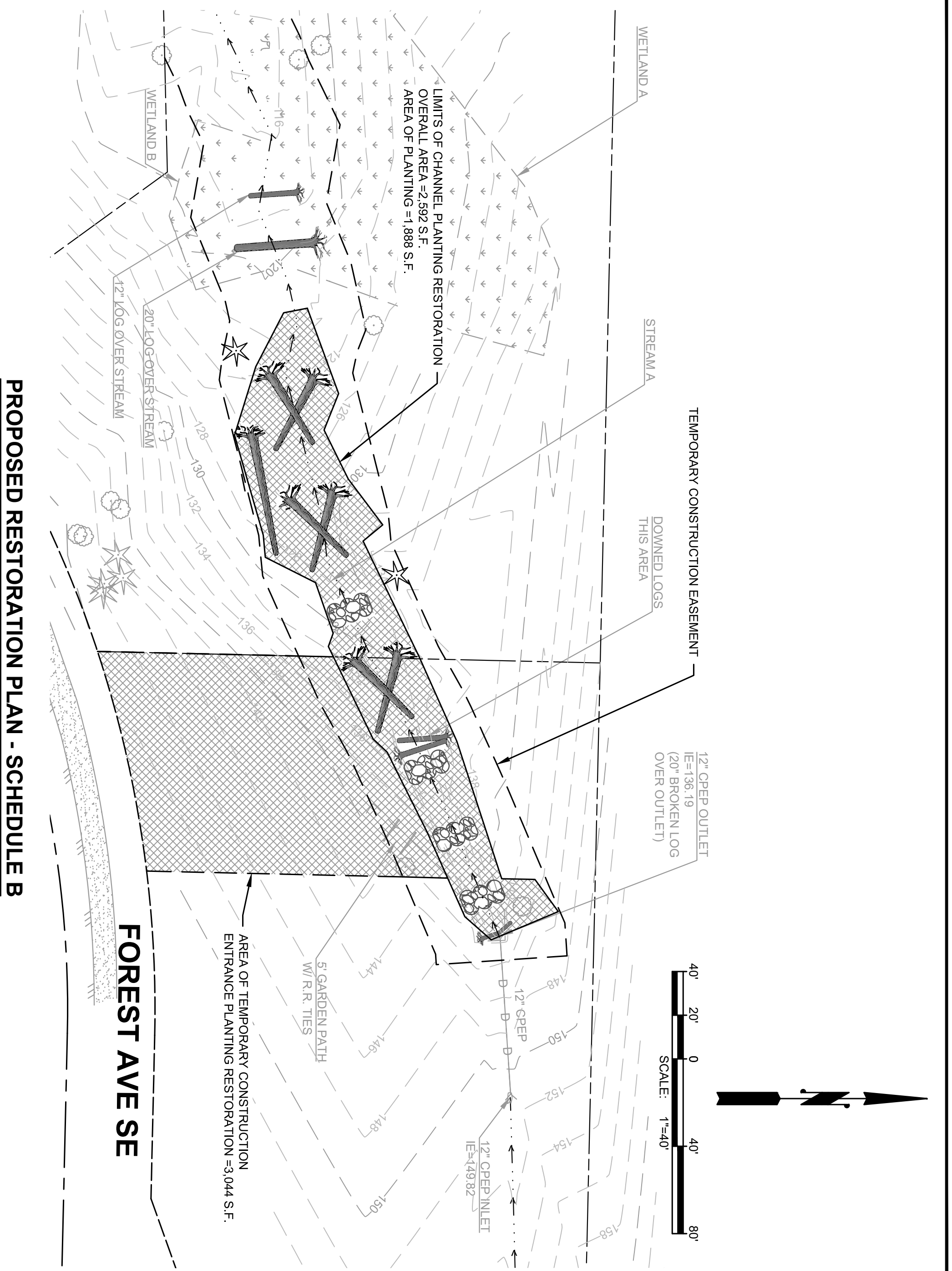

PROPOSED RESTORATION PLAN - SCHEDULE B

PLANT SCHEDULE

PLANTING AREA	SYMBOL	SPECIES	SPACING (O.C.)	QTY	TYPE & SIZE	NOTES	
TOTAL AREA OF SCHEDULE A PLANTING AREA 1,888 S.F.	★	<i>Thuja plicata</i>	WESTERN RED CEDAR	10'	2	5-GALLON CONTAINER	AS NOTED ON PLANS
		<i>Rubus spectabilis</i>	SALMONBERRY	4'	15	1-GALLON CONTAINER	PLANT IN SINGLE-SPECIES GROUPS OF 2-3 PLANTS
		<i>Symphoricarpos albus</i>	SNOWBERRY	4'	15	1-GALLON CONTAINER	PLANT IN SINGLE-SPECIES GROUPS OF 2-3 PLANTS
		<i>Rosa nutkana</i>	NOOTKA ROSE	4'	15	1-GALLON CONTAINER	PLANT IN SINGLE-SPECIES GROUPS OF 2-3 PLANTS
		<i>Athyrium ilix-femina</i>	LADY FERN	1.5'	30	1-GALLON CONTAINER	PLANT IN SINGLE-SPECIES GROUPS OF 2-3 PLANTS
		<i>Tellima grandiflora</i>	FRINGE CUP	1.5'	30	1-GALLON CONTAINER	PLANT IN SINGLE-SPECIES GROUPS OF 2-3 PLANTS
		<i>salix lucinda</i>	PACIFIC WILLOW	12"	80	LIVE STAKE	AS NOTED ON PLANS
		See Spec	GRASS MIX	---	---	---	

NOTE: GRASS MIX SHALL CONSIST OF NATIVE SPECIES OF FESCUE CONTAINING VARIOUS PROPORTIONS OF RED FESCUE (*FESTUCA RUBRA*), TALL FESCUE (*FESTUCA ARUNDINACEA*), AND WESTERN FESCUE (*FESTUCA OCCIDENTALIS*). SEEDS SHALL BE "WEED FREE" INDICATING THERE ARE NO NOXIOUS OR NUISANCE WEEDS IN THE SEED.

Reference Number:
 Applicant Name: City of Mercer Island
 Proposed Project: Watercourse Stabilization Projects
 Locations (2): W. Mercer Way & Forest Ave SE
 Page 13 of 13 Date: December, 2022